

EXP-79

REVISION: -
ECO NO.: -
BY: G. REEDER
DATE: 8/4/06

COXREELS SERIES S19"

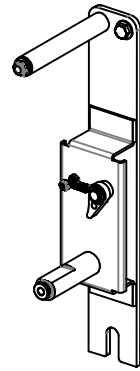

SR19 SERIES

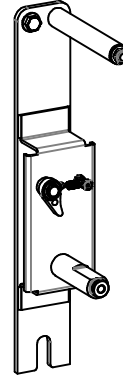

SL19 SERIES

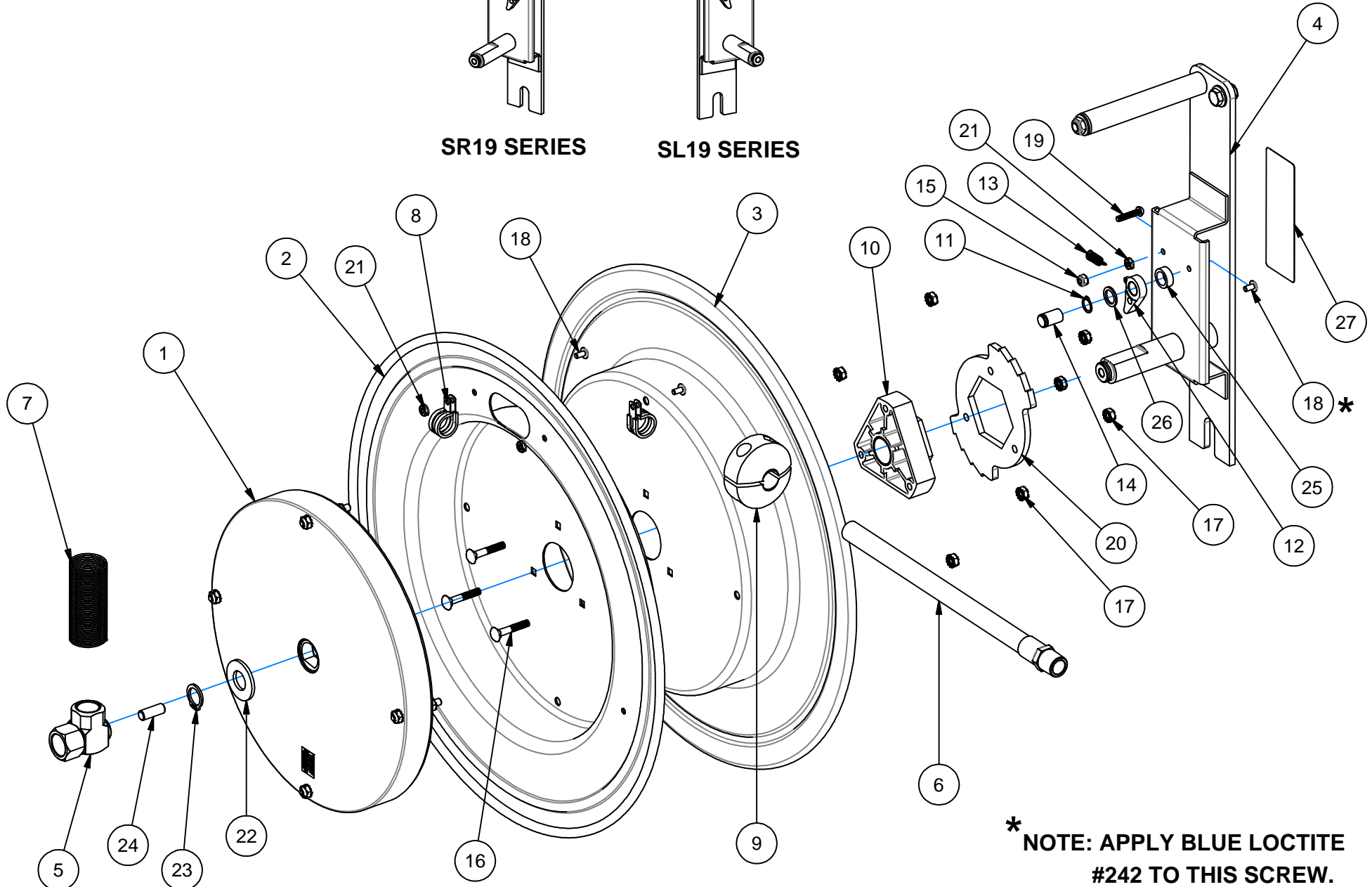

* NOTE: APPLY BLUE LOCTITE
#242 TO THIS SCREW.

EXP-79

COMMON PARTS TO ALL SERIES S19" REELS

ITEM NO.	PART NO.	DESCRIPTION	QTY.
10	1776-3	ASSY., HUB BEARING	1
11	6326	RING, RETAINING	1
12	640-1-SS	CAM, LOCKING	1
13	274-1-SS	SPRING, DOG	1
14	8423	PIN, LOCKING CAM	1
15	7050	NUT, #10-32 NYLOCK	1
16	1953	CARRIAGE BOLT, 1/4-20 x 1.5	3
17	125	NUT, KEPS, 1/4-20	7
18	245	SCREW, TRUSS HD. 10-32x3/8"	3
19	8485	SCREW, #10-32 X 1" ROUND HEAD	1
20	1924	RING, LOCKING	1
21	130	NUT, #10-32 KEPS	3

ITEM NO.	PART NO.	DESCRIPTION	QTY.
22	1755-1	WASHER, SPACER HDPE	1
23	1753	RING, RETAINING	1
24	10235-SS	STUD, 3/8-16 X 1" SS	1
25	6440-SS	SPACER, SS	1
26	6441-1	WASHER, SPACER HDPE	1
27	10925-5	LABEL, STD ID	1

ITEM NUMBER

LOW PRESSURE	MODEL	1	2	3	4	5	* 6			* 7	8	* 9
		SPRING	DISK	DISK	BASE	SWIVEL	HOSE (STD)	HOSE (-OG)	HOSE (-RH)	HOSE GRD	CLAMP (2)	BALL STOP
	SR19-L450	691-3	1703	1702	8616-R	439	5154-50	5131-50	5066-50	398-1	383	131-4
	SL19-L450	691-3R	1703	1702	8616-L	439	5154-50	5131-50	5066-50	398-1	383	131-4

ITEM NUMBER

MEDIUM PRESSURE	MODEL	1	2	3	4	5	* 6	* 7			8	* 9
		SPRING	DISK	DISK	BASE	SWIVEL	HOSE (STD)	HOSE GRD	CLAMP (2)	BALL STOP		
	SR19-M350	646	1703	1702	8616-R	1935	5224-50	237-1	381	131-3		
	SL19-M350	646R	1703	1702	8616-L	1935	5224-50	237-1	381	131-3		
	SR19-M450	696-1	1703	1702	8618-R	439	5256-50	398-1	383	131-4		
	SL19-M450	696-1R	1703	1702	8618-L	439	5256-50	398-1	383	131-4		

ITEM NUMBER

HIGH PRESSURE	MODEL	1	2	3	4	5	* 6	* 7			8	* 9
		SPRING	DISK	DISK	BASE	SWIVEL	HOSE (STD)	HOSE GRD	CLAMP (2)	BALL STOP		
	SR19-H150	646	1703	1702	8616-R	499	5304-50	237-1	115	131		
	SL19-H150	646R	1703	1702	8616-L	499	5304-50	237-1	115	131		
	SR19-H350	696-1	1703	1702	8618-R	521	5336-50	237-1	613	131-3		
	SL19-H350	696-1R	1703	1702	8618-L	521	5336-50	237-1	613	131-3		

* ON "LESS HOSE" MODELS (SR19L-, SL19L-) EXCLUDE ITEMS #6,#7, AND #9.

REEL ASSEMBLY REPORTS R100 (LATCHOUT REMOVAL), R101 (LOCKING RING PLACEMENT), R112 (TIGHTENING AND TORQUING)

REVISION: -

ECO: -

DATE: 8/3/2006

NAME: G. REEDER